



# ATH 500 M, DN 100 ISO-K, Remote, Air cooled, Non-heated

ATH 500 M, DN 100 ISO-K, Remote, Air cooled, Non-heated



Similar Image

## ATH 500 M, DN 100 ISO-K, Remote, Air cooled, Non-heated

- 5-axis magnetically levitated turbopump with drag stage for a pump speed of up to 350 l/s for N<sub>2</sub>
- DN 100 ISO-K inlet flange
- Compact integrated drive electronics
- Installation in any orientation
- Remote, Air cooled, Non-heated
- CE marked and ROHS compliant

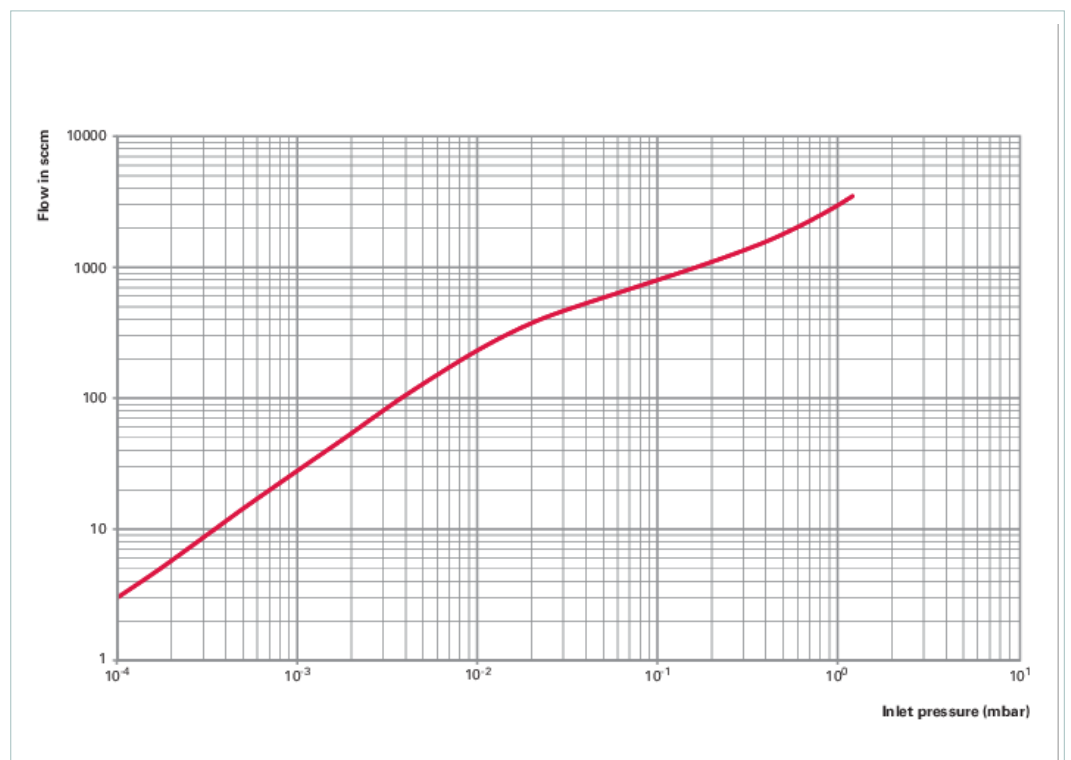
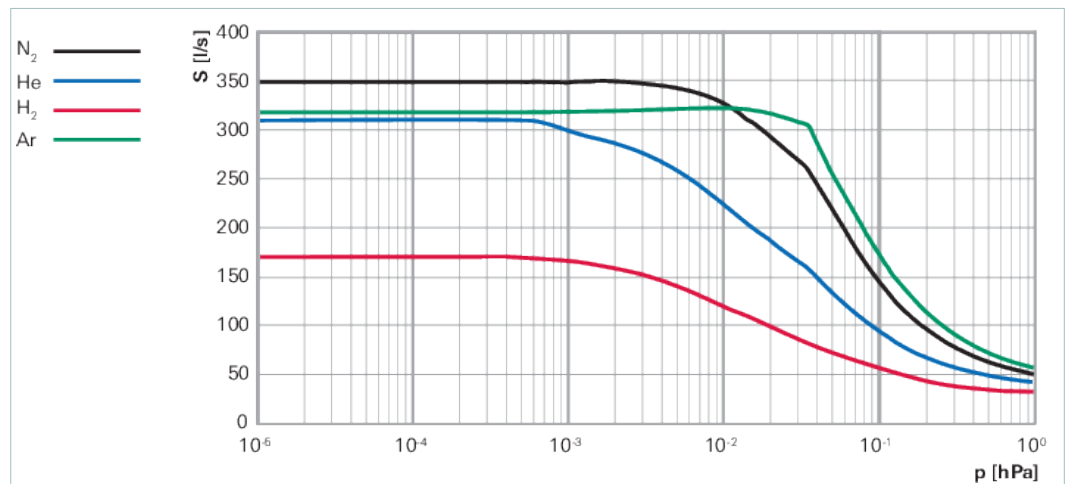

## Dimensions

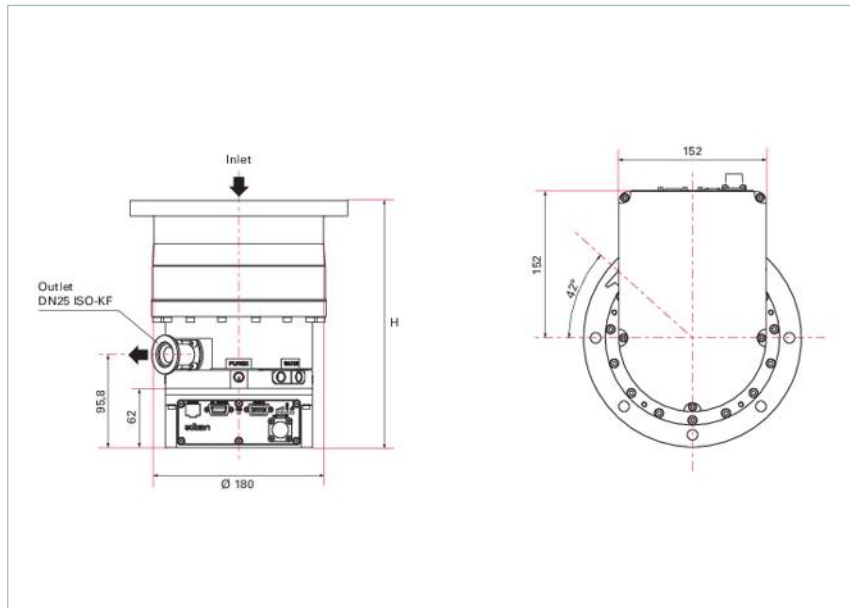

H 294.5 mm

Technical Data	ATH 500 M, DN 100 ISO-K, Remote, Air cooled, Non-heated
Bearing	Magnetically Levitated
Compression ratio for Ar	$> 8 \cdot 10^6$
Compression ratio for H <sub>2</sub>	$> 2 \cdot 10^2$
Compression ratio for He	$> 1 \cdot 10^4$
Compression ratio for N <sub>2</sub>	$> 2 \cdot 10^7$
Cooling method, optional	Air
Cooling method, standard	Water
Electronic drive unit	Integrated drive electronics
Flange (in)	DN 100 ISO-K
Flange (out)	DN 25 ISO-KF
Fore-vacuum max. for N <sub>2</sub>	2.6 hPa   1.95 Torr   2.6 mbar
Gas throughput for Ar	42.3 hPa l/s   31.73 Torr l/s   42.3 mbar l/s
Gas throughput for H <sub>2</sub>	$> 169$ hPa l/s   $> 126.75$ Torr l/s   $> 169$ mbar l/s
Gas throughput for He	$> 169$ hPa l/s   $> 126.75$ Torr l/s   $> 169$ mbar l/s
Gas throughput for N <sub>2</sub>	67.6 hPa l/s   50.7 Torr l/s   67.6 mbar l/s
Interfaces	Remote
Mounting orientation	in any orientation
Operating voltage	48 ( $\pm 5\%$ ) V DC
Power consumption at ultimate pressure	100 W
Pumping speed for Ar	320 l/s
Pumping speed for H <sub>2</sub>	170 l/s
Pumping speed for He	310 l/s
Pumping speed for N <sub>2</sub>	350 l/s
Rotation speed $\pm 2\%$	50,000 rpm   50,000 min <sup>-1</sup>
Run-up time	$< 2$ min
Ultimate pressure	$< 1 \cdot 10^{-8}$ hPa   $< 7.5 \cdot 10^{-9}$ Torr   $< 1 \cdot 10^{-8}$ mbar
Weight	17 kg   37.48 lb

### Order number

ATH 500 M

V2311100

<b>Accessories</b>	
<b>Electronic controllers</b>	
External power supply for ATH 500 M/MT	<b>114866</b>
Hand Held Remote (HHR) with cable	<b>114461</b>
<b>Inlet screen</b>	
Stainless inlet screen kit for DN100	<b>118001</b>
<b>Power cord</b>	
Power cord 2.0 m Europe standard 200 - 240 V AC 48 VDC power supply (for ATH500M)	<b>103566</b>
Power cord 2.0 m US standard 200 - 240 V AC 48 VDC power supply (for ATH500M)	<b>103567</b>
Power cord 3.5 m 48 V DC (for ATH 500 M)	<b>A331328-035</b>
<b>Venting valves and other accessories</b>	
Air cooling kit (for ATH 500 M)	<b>118543S</b>
Air venting valve (for ATH 500 M)	<b>200043</b>
Purge plug with O-ring (for ATH 500 M)	<b>115298S</b>
Purge valve kit 24 DVC (for ATH 500 M)	<b>115303S</b>

## **VACUUM SOLUTIONS FROM A SINGLE SOURCE**

Pfeiffer Vacuum stands for innovative and custom vacuum solutions worldwide, technological perfection, competent advice and reliable service.

## **COMPLETE RANGE OF PRODUCTS**

From a single component to complex systems:

We are the only supplier of vacuum technology that provides a complete product portfolio.

## **COMPETENCE IN THEORY AND PRACTICE**

Benefit from our know-how and our portfolio of training opportunities!

We support you with your plant layout and provide first-class on-site service worldwide.

Are you looking for a  
perfect vacuum solution?  
Please contact us:

**Pfeiffer Vacuum GmbH**  
Headquarters · Germany  
T +49 6441 802-0  
info@pfeiffer-vacuum.de

[www.pfeiffer-vacuum.com](http://www.pfeiffer-vacuum.com)

All data subject to change without prior notice.

**PFEIFFER**  **VACUUM**